





Fiori Pediatrics is a children's health care center offering a complete range of pediatric care in Seattle, Washington. The design for the center is inspired by the intricate glass sculptures designed by Dale Chihuly and his museum located in downtown Seattle. Chihuly uses form and color to capture the imagination of others and challenges the conventional ideas of function and beauty. The unique aspect of glass blowing and his designs spark curiosity in those of all ages. The organic shapes and bold colors in his exhibit, Fiori, resemble the exuberant and ambitious nature of children while also being delicate in form. With this in mind, the atmosphere will be inviting to kids and parents alike through whimsical architectural details, a warm color scheme, and an interactive waitingcolor



PROVIDE an engaging and welcoming atmosphere to ease patient anxiety.

CULTIVATE positive employee mentality.

EXECUTE a clear path of circulation.



Color: Cool colors are beneficial to patients with anxiety.
Absence of visual variety lead to sensory deprivation.



Flooring: VCT provides durable properties & easy

	Quantity	Aspirable SF	Non-Aspirable SF	Public Access	High Traffic	High Visibility	Special Considerations
2 Reception	1	300	300	●	●	●	Open recept. & built-in lockers
3 Workroom	1	200	200	X	●	●	18 in. x 18" deep shelves. Coat closet w/ in. & clothing rod. Worktable 10-12 sq. ft.
4 Nurses Station	1	300	300	●	●	●	Weight scales
5 Consulting Office	3	180	540	○	●	●	One desk
6 Employee Restroom	1	150	150	X	X	●	One stall, 30 in. x of sloping 12" slope
7 Pharmacy	1	80	80	X	X	●	Lavatory, toilet, separate shower room
8	1	150	150	X	●	●	Should not be directly accessible to patients. At least 8 employees and kitchen with fridge, sink, dishwasher, ice machine, and microwave. Dishcloths not required.
PATIENT AREAS							
10 Waiting Area	1	500	500	●	●	●	Seating for 15 adults and 10 children, 100-200 sq. ft. of play area
11 Exam Rooms	9	90	810	●	●	●	Separate sink and well areas required. 85-100 sq. ft. Two should be bigger to accommodate mult. children or procedures. Not restricted by conventional distance requirements to plumbing waste lines.
12 Patient Restrooms	2	80	160	●	X	●	Lavatory and toilet. One located near waiting and one near exam rooms.
13 Secondary Waiting	1	100	100	●	●	X	Located close to main waiting. Seats 4 children and 4 adults.
14							
15							
16							
17							
18							
19							
20							
21							
A Total Aspirable SF		1700	1700	Sum of SF in table A			
B Circulation %		20	340	See A x Circulation Multiplier			
C Multiplier		75	127.5				
D Total Usable SF Req		127.5	127.5				
E Available		127.5	127.5				
F Over/Under							

Required ● Important ○ Detrimental X

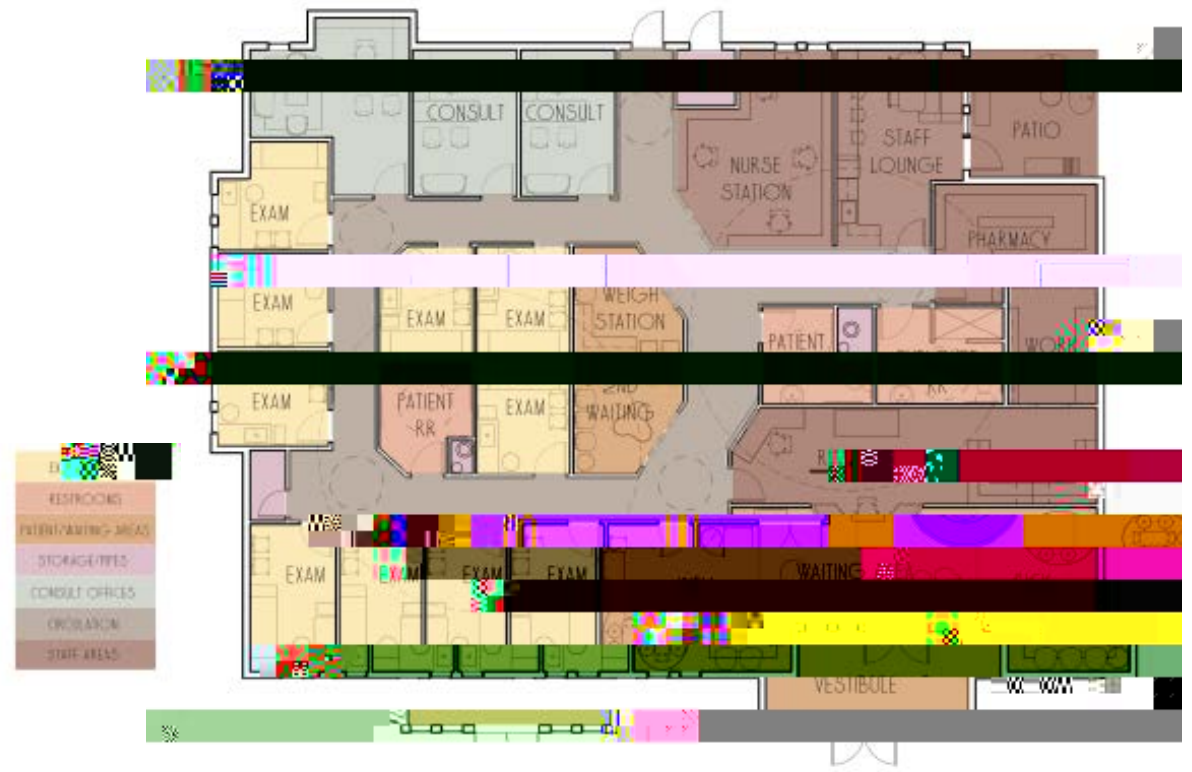
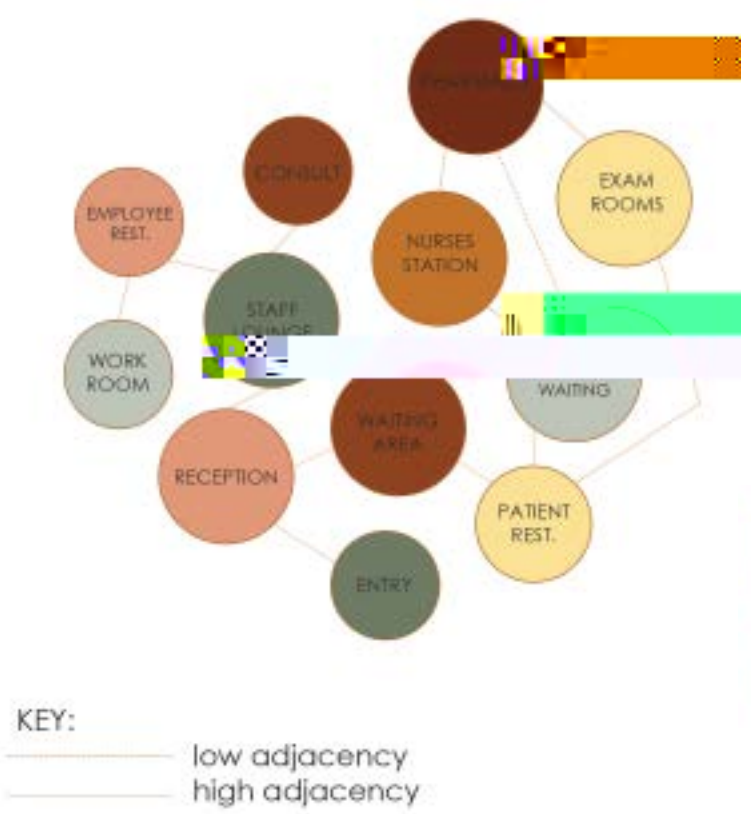



FURNITURE LE











The floorplan of Fiori Pediatrics has a path of travel which allows patients and visitors to navigate through the space with ease. Along with a clear path of circulation, color coded doorframes provide as a means of wayfinding to direct patients to the correct location. The nurse's station is centrally located in order for the nurses to access the waiting room and exam rooms. Patient areas are separate from the staff areas to ensure the safety of patients. Staff areas are located near a secondary exit at the rear of the building to allow them to come and go without adding congestion to the waiting areas.

Program Use Square Footage Requirements

Project: Fiori Pediatrics

Kennedy M., Allie K., Emily P., Kyra F.

Space	Quantity	Assignable SF	SUBTotal ASF (= quantity x asf)	Actual Sq. F.	
NON-PATIENT AREAS					
2 Reception/Business Office	1	300	300	326	Open business office. Worktable 10-12 sq. ft.
3 Workroom	1	200	200	108	18 in. ft. of worktable 10-12 sq. ft.
4 Nurses Station	1	300	300	225	Weight and blood pressure station w/2 chairs. Worktable 10-12 sq. ft. Laboratory sink.
5 Consulting Offices	3	180	540	436	Desk w/12-15 sq. ft. chairs. 36 in. ft. of worktable. 1-2 guests.
6 Employee Restroom	1	150	150	104	Lavatory, toilet, separate shower room.
7 Pharmacy/Storage Area	1	80	80	134	Shower, sink, counter, machine, and microwave. Oven/stove not required.
8 Staff Lounge	1	150	150	198	
PATIENT AREAS					
10 Waiting Area	1	500	500	568	Seating for 15 adults and 10 children. 100-200 sq. ft. of play area. Separate sick and well areas required.
11 Exam Rooms	9	90	810	888	95-100 sq. ft. per room. Should be designed to accommodate individual procedures. Not restricted by conventional distance requirements to plumbing waste lines.
12 Patient Restrooms	2	80	160	166	Lavatory and toilet. One located near waiting and one near exam rooms.
13 Secondary Waiting	1	100	100	92	Located close to main waiting. Seats 4 children and 4 adults.
A Total Assignable SF			3,290	3,243	
Circulation % 26					
Multiplier 35					end.
C Total Usable SF Req.			4,442	4,400	
D Available			4,400	4,400	
E Over/Under			-42		

Required ● Important X

